

**KINSHOFER** manufactures rotators for truck loaders, excavators and logging operations. Years of experience in designing rotators and hydraulic load handling equipment guarantee high efficiency, long lasting rotators, specially tailored to meet your requirements. The gear-type design ensures a very compact and powerful rotator. The precision control and braking ability is especially appreciated by operators. A grapple does not rotate unexpectedly when digging, even under maximum load, and there is no need for stability compensation when handling longer lengths of timber...

These are only some of the many working situations where operators appreciate the advantages of using **KINSHOFER**-rotators.



### **KINSHOFER**-Rotators are the solution.

#### Features of the **KINSHOFER**-Rotators

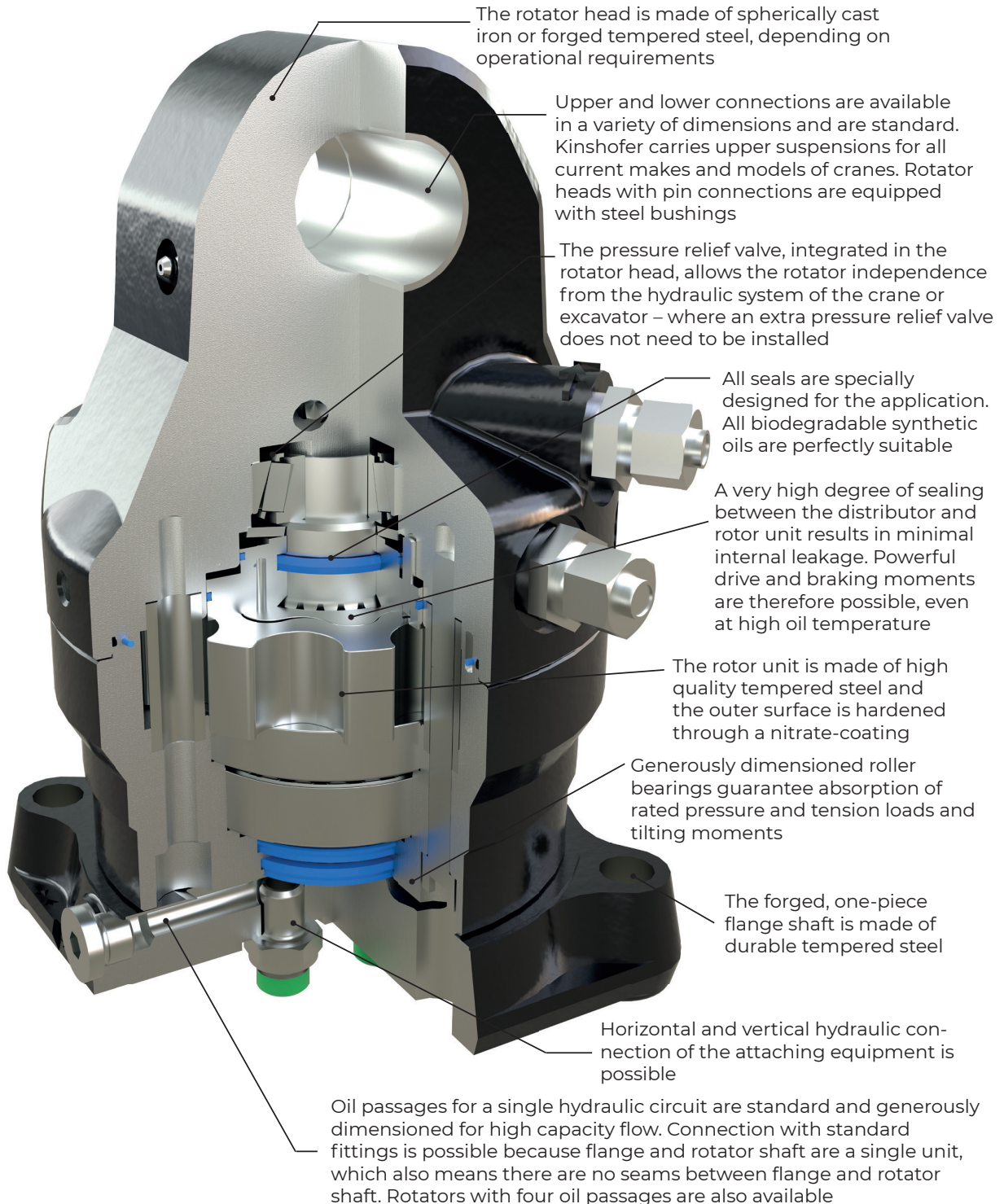

## Rotator with shaft up to 3000 kg load capacity (incl. fittings)

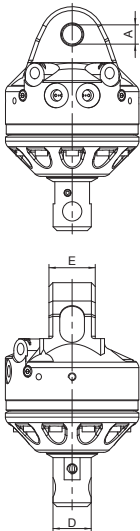

**KM 03 S**

Type	Load capacity (kg)	Shaft Ø D (mm)	Upper connection (Width E x Pin-Ø A) (mm)	Torque (Nm)	Moment of deflection max. (Nm)	Self weight (kg)
<b>KM 03 S*</b>	3000	49.5	60 x 25	450	1750	24

\* only for pallet forks

<b>Operating pressure:</b>	max. 37 MPa (370 bar)
<b>Oil flow rotate:</b>	max. 40 l/min
<b>Oil flow feedthrough:</b>	max. 75 l/min
<b>Hydraulic coupling in:</b>	G 3/8"
<b>Hydraulic coupling out:</b>	G 1/4"

## Rotators with shaft up to 4500 kg load capacity (incl. fittings)

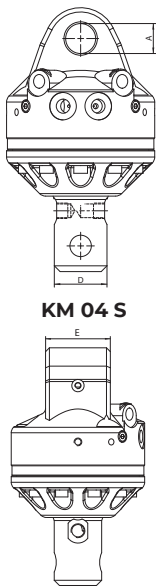

**KM 04 S**



**KM 04 S69-30**

Type	Load capacity (kg)	Shaft Ø D (mm)	Upper connection (Width E x Pin-Ø A) (mm)	Torque (Nm)	Moment of deflection max. (Nm)	Self weight (kg)
<b>KM 04 S59-30</b>	4500	59	84 x 30	850	3000	26
<b>KM 04 S</b>	4500	62	84 x 30	850	3000	26
<b>KM 04 S63-30</b>	4500	63	84 x 30	850	3000	26
<b>KM 04 S68-30</b>	4500	68	84 x 30	850	3000	26
<b>KM 04 S68-30US*</b>	4500	68	84 x 30	1000	4500	28
<b>KM 04 S69-30</b>	4500	69	84 x 30	850	3000	26

\* steel motor-head

<b>Operating pressure:</b>	max. 37 MPa (370 bar)
<b>Oil flow rotate:</b>	max. 40 l/min
<b>Oil flow feedthrough:</b>	max. 75 l/min
<b>Hydraulic coupling:</b>	G 1/2"

## Rotators with flange up to 4500 kg load capacity (incl. fittings)

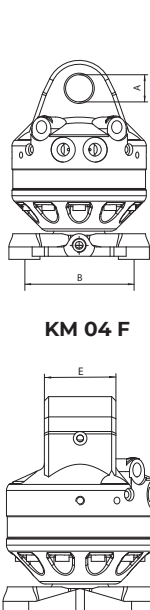

**KM 04 F**



**KM 04 F**



**KM 04 F140-30US**

Type	Load capacity (kg)	Hole pattern of flange B (mm)	Upper connection (Width E x Pin-Ø A) (mm)	Torque (Nm)	Moment of deflection max. (Nm)	Self weight (kg)
<b>KM 04 F</b>	4500	□140	84 x 30	850	3000	26
<b>KM 04 F140-30US*</b>	4500	□140	84 x 30	1000	8500	31
<b>KM 04 F140-30V**</b>	4500	□140	84 x 30	850	3000	26
<b>KM 04 F140-30LM***</b>	4500	□140	84 x 30	850	3000	26

\* steel motor-head

\*\* additional vertical connection

\*\*\* low maintenance with plastic bushings and additional vertical connection

<b>Operating pressure:</b>	max. 37 MPa (370 bar) (LM-version max. 32 MPa (320 bar))
<b>Oil flow rotate:</b>	max. 40 l/min
<b>Oil flow feedthrough:</b>	max. 75 l/min
<b>Hydraulic coupling:</b>	M18 x 1,5

## Rotators with shaft up to 6000 kg load capacity (incl. fittings)

Type	Load capacity (kg)	Shaft $\varnothing$ D (mm)	Upper connection (Width E x Pin- $\varnothing$ A) (mm)	Torque (Nm)	Moment of deflection max. (Nm)	Self weight (kg)
<b>KM 06 S68-40</b>	6000	68	84 x 40	1000	4500	32
<b>KM 06 S69-40</b>	6000	69	84 x 40	1000	4500	32

<b>Operating pressure:</b>	max. 37 MPa (370 bar)
<b>Oil flow rotate:</b>	max. 40 l/min
<b>Oil flow feedthrough:</b>	max. 75 l/min
<b>Hydraulic coupling in:</b>	G 1/2"
<b>Hydraulic coupling out:</b>	M18 x 1,5



**KM 06 S68-40**

## Rotator with flange up to 6000 kg load capacity (incl. fittings)

Type	Load capacity (kg)	Hole pattern of flange B (mm)	Upper connection (Width E x Pin- $\varnothing$ A) (mm)	Torque (Nm)	Moment of deflection max. (Nm)	Self weight (kg)
<b>KM 06 F140-40</b>	6000	□140	84 x 40	1000	8500	34

<b>Operating pressure:</b>	max. 37 MPa (370 bar)
<b>Oil flow rotate:</b>	max. 40 l/min
<b>Oil flow feedthrough:</b>	max. 75 l/min
<b>Hydraulic coupling in:</b>	G 1/2"
<b>Hydraulic coupling out:</b>	M18 x 1,5



## Technical drawings

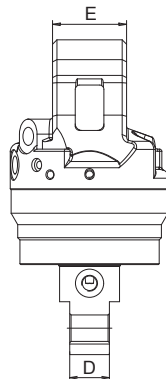
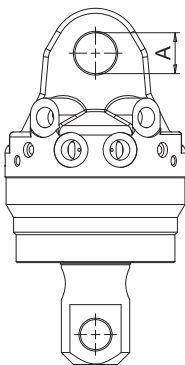

**KM 06 S68-40 / KM 06 S69-40**

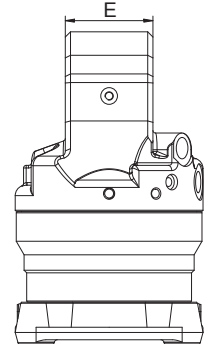
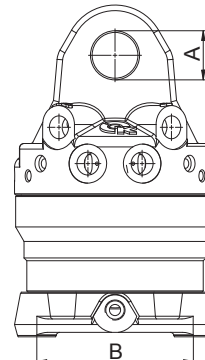

**KM 06 F140-40**